

**First Floor**



Elevation A



Elevation B



Elevation C

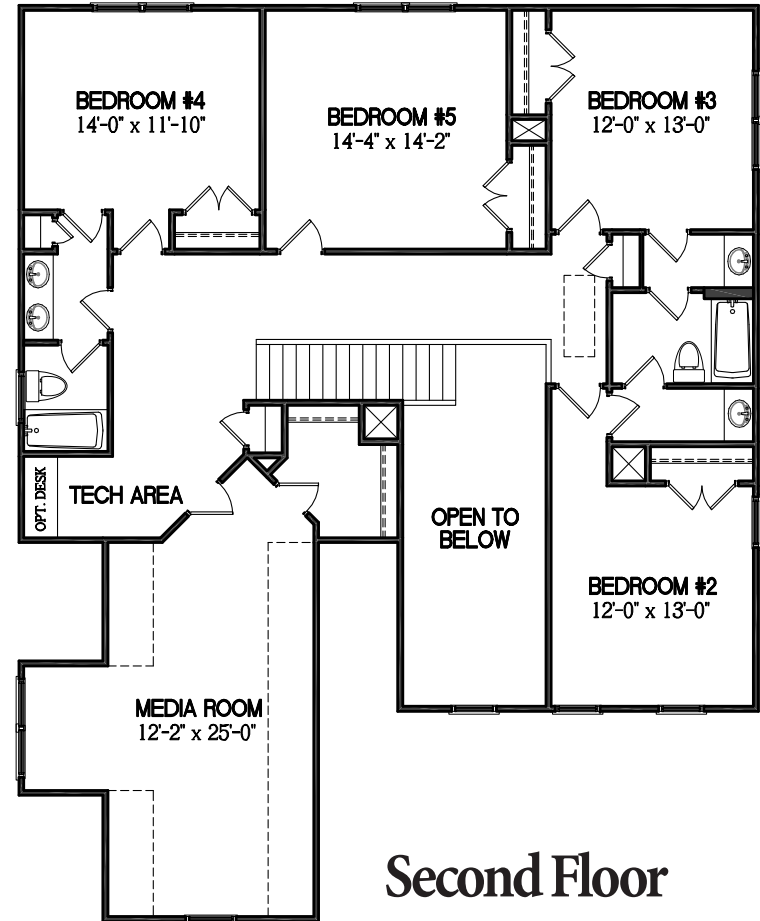

**Second Floor**

# THE MAPLE - 3,398 sq.ft.\*

**5 Bedrooms / 3.5 Baths Downstairs Master / Media Room**



FONVILLE MORISEY & BAREFOOT  
NEW HOME SALES & MARKETING

\*Rendering, floorplan and specifications are approximate and subject to change. 6/10

**ForeverHome**  
Building Dreams That Last  
www.TuscanyForeverHome.com